



3 bed terraced house to buy in

North Street, Otley, West Yorkshire, LS21 1AH

£199,000 Starting Bid

 x3  x1  x1

Tenure

Freehold

Property features

- ✓ Immediate 'exchange of contracts' available
- ✓ Being sold via 'Secure Sale'
- ✓ Victorian Stone Through Terrace
- ✓ Potential to Further Improve
- ✓ EPC Rating D

Key Information

- ✓ Council Tax: Band C
- ✓ EPC Rating: D
- ✓ Heating supply: Gas
- ✓ Electric supply: National Grid
- ✓ Water supply: Direct mains water
- ✓ Broadband: None
- ✓ Mobile signal: Good

Description

Being sold via Secure Sale online bidding. Terms & Conditions apply. Starting Bid £199,000

A Victorian stone built three double bedroom terrace home situated over three floors with useful cellars with potential for further development (subject to required building regulations and planning permission) situated in a central location in the sought after market town of Otley. Will be of particular interest to developers or DIY enthusiasts seeking a well located character property with huge potential. Benefits from: Large bathroom with 4 piece suite; astro and patio gardens; potential for off street parking to rear; dining kitchen; white Upvc double glazing; gas central heating with combination boiler; large master bedroom. Offers excellent access to local amenities, cafes, bars, restaurants, primary schools and Prince Henry's Grammar School as well as commuting access to both Leeds and Harrogate. An early inspection is recommended to appreciate the location, charm and potential of this character property.

LOUNGE 12' 2" x 11' 5" (3.71m x 3.48m) max

DINING KITCHEN 15' 0" x 12' 3" (4.57m x 3.73m) max

CELLAR ROOM 1 12' 3" x 11' 9" (3.73m x 3.58m) max

CELLAR ROOM 2 12' 3" x 11' 5" (3.73m x 3.48m) max

1ST FLOOR STAIRCASE & LANDING 12' 4" x 5' 8" (3.76m x 1.73m) max

DOUBLE BEDROOM 1 12' 3" x 11' 6" (3.73m x 3.51m) max

BATHROOM 12' 3" x 8' 9" (3.73m x 2.67m) max

2ND STAIRCASE & LANDING 6' 1" x 2' 9" (1.85m x 0.84m) max

BEDROOM 2 10' 10" x 8' 1" (3.3m x 2.46m)

BEDROOM 3 10' 10" x 7' 7" (3.3m x 2.31m)

EXTERIOR

Council Tax Band: C

Tenure: Freehold

Price: Starting Bid £199,000

Property Type: Terraced House

Parking: None

Construction materials: Stone built

Roofing type: Slate tiles

Risk of floods and or erosion: No

Flooded in last 5 years: No

Flood defences: No

Planning permissions or proposals for development: No

Listed property: No

Conservation area: No

Public rights of way: No

Adaptions for accessibility: No

Restrictions: No

Required access: No

Heating: Gas

Electric: National Grid

Water: Direct mains water

Sewerage: Standard UK domestic

Air conditioning: No

Broadband: None

Mobile signal coverage: Good

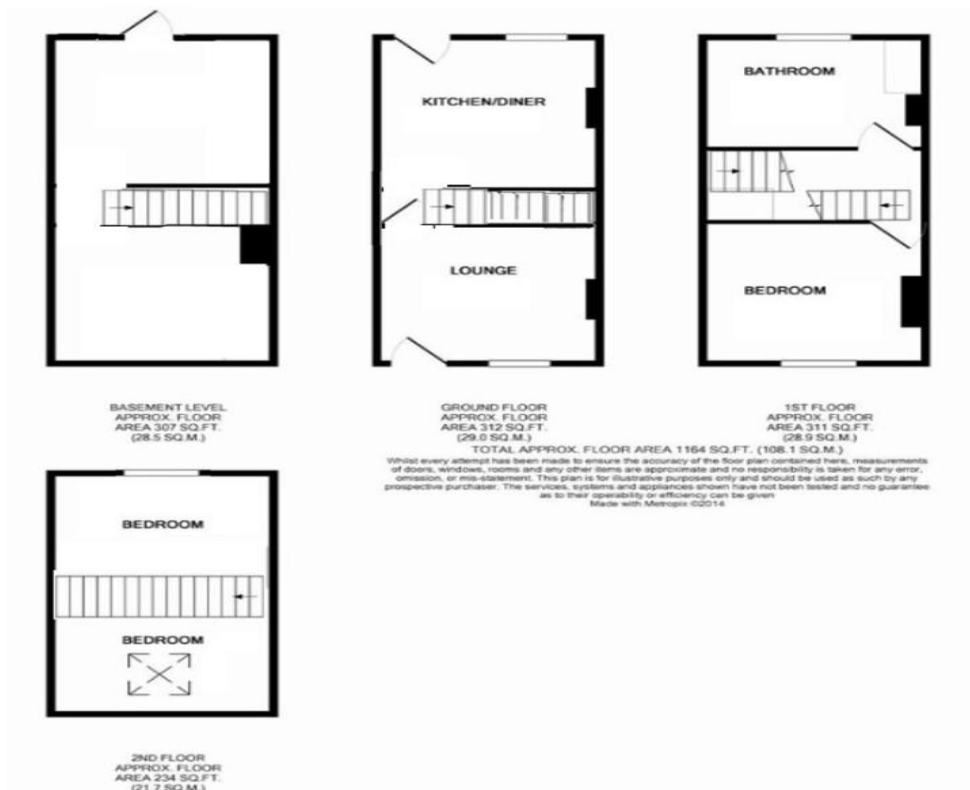

Energy Efficiency Rating		Current	Potential
<i>Very energy efficient - lower running costs</i>			
(92-100) A			
(81-91) B			85
(69-80) C			
(55-68) D		59	
(39-54) E			
(21-38) F			
(1-20) G			
<i>Not energy efficient - higher running costs</i>			
England, Scotland & Wales		EU Directive 2002/91/EC	

North Street, Otley, West Yorkshire, LS21 1AH

Contact your local branch today for more information on this property:

235 Church Street, Blackpool, Lancashire, FY1 3PB, <http://www.kenricksestateagents.co.uk/>

These particulars, whilst believed to be accurate are set out as a general outline only for guidance and do not constitute any part of an offer or contract. Intending purchasers should not rely on them as statements of representation of fact, but must satisfy themselves by inspection or otherwise as to their accuracy. No person in this firm's employment has the authority to make or give any representation or warranty in respect of the property.

