



2 bed terraced house to buy in

Handsworth Road, Blackpool, Blackpool,
Lancashire, FY1 2QZ

£65,000 Starting Bid

 x2  x1  x1

Tenure

Freehold

On Street parking

Property features

- ✓ Being Sold via Secure Sale online bidding. Terms and Conditions
- ✓ Vacant Possession
- ✓ Entrance Vestibule, Lounge, Modern Kitchen/Diner
- ✓ 2 Double Bedrooms, 3 piece suite Bathroom
- ✓ EPC Rating C

Key Information

- ✓ Council Tax: Band A
- ✓ EPC Rating: C
- ✓ Heating supply: Gas
- ✓ Electric supply: National Grid
- ✓ Water supply: Direct mains water
- ✓ Broadband: Cable
- ✓ Mobile signal: Good

Description

Nestled in a sought-after location, this charming 2-bedroom mid-terraced house presents an exceptional investment opportunity.

The property features an entrance vestibule leading to a lounge and a modern kitchen/diner, providing a comfortable living space.

Upstairs, there are two generously-sized double bedrooms and a three-piece suite bathroom.

Notably, the south-facing garden to the rear offers a private outdoor retreat, perfect for relaxation and al fresco dining.

Additionally, the property benefits from its prime position in close proximity to local schools and convenient transport links, enhancing its desirability.

Council Tax Band: A

Tenure: Freehold

Price: Starting Bid £65,000

Property Type: Terraced House

Parking: On Street

Construction materials: Brick and block

Roofing type: Slate tiles

Risk of floods and or erosion: No

Flooded in last 5 years: No

Flood defences: No

Planning permissions or proposals for development: No

Coalfield or mining area: No

Listed property: No

Conservation area: No

Public rights of way: No

Adaptions for accessibility: No

Restrictions: No

Required access: No

Heating: Gas

Electric: National Grid

Water: Direct mains water

Water meter: No

Sewerage: Standard UK domestic

Air conditioning: No

Broadband: Cable

Mobile signal coverage: Good

Entrance Vestibule

Entrance Vestibule

1.19m x 1.07m

Lounge

Lounge

3.73m x 4.32m

Kitchen/Diner

Kitchen/Diner

4.06m x 4.27m

Bedroom 1

Bedroom 1

3.77m x 4.31m

Bedroom 2

Bedroom 2

3.08m x 2.8m

Bathroom

Bathroom

2.16m x 1.41m

Rear Garden

Rear Garden

Low maintenance flagged garden to the rear.

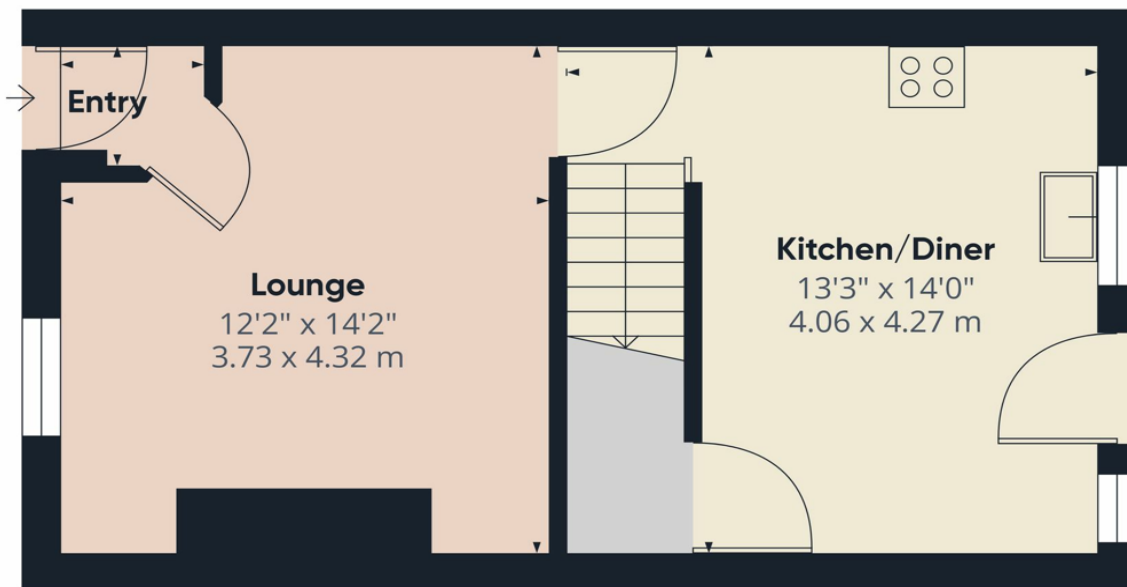

Approximate total area⁽¹⁾
350.15 ft²
32.53 m²

(1) Excluding balconies and terraces

While every attempt has been made to ensure accuracy, all measurements are approximate, not to scale. This floor plan is for illustrative purposes only.

Calculations are based on RICS IPMS 3C standard.

GIRAFFE360

Floor 1

Energy Efficiency Rating		Current	Potential
<i>Very energy efficient - lower running costs</i>			
(92-100) A			
(81-91) B			87
(69-80) C		75	
(55-68) D			
(39-54) E			
(21-38) F			
(1-20) G			
<i>Not energy efficient - higher running costs</i>			
England, Scotland & Wales		EU Directive 2002/91/EC	

Handsworth Road, Blackpool, Blackpool, Lancashire, FY1 2QZ

Contact your local branch today for more information on this property:

235 Church Street, Blackpool, Lancashire, FY1 3PB, <http://www.kenricksestateagents.co.uk/>

These particulars, whilst believed to be accurate are set out as a general outline only for guidance and do not constitute any part of an offer or contract. Intending purchasers should not rely on them as statements of representation of fact, but must satisfy themselves by inspection or otherwise as to their accuracy. No person in this firm's employment has the authority to make or give any representation or warranty in respect of the property.

