



### 3 bed pair of flats to buy in DH9

Mitchell Street, South Moor, Stanley,  
Durham, DH9 7BE

**£80,000** Starting Bid

 x 3  x 2  x 2

Tenure

**Leasehold**

### Property features

- ✓ Potential Rent £825 pcm
- ✓ Three bedrooms
- ✓ Pair of flats
- ✓ Both flats are tenanted
- ✓ EPC Rating D

On Street parking

## Key Information

- ✓ Council Tax: Band A
- ✓ EPC Rating: D
- ✓ Heating supply: Gas

## Description

TO BE SOLD VIA Online Auction. Fees Apply

We are delighted to offer this well three bedroom pair of flats situated in south moor close to local amenities and excellent transport links. The property is benefits from gas central heating, private rear yard to each flat.

The accommodation briefly comprises of:- Ground floor:- Entrance hallway, lounge, kitchen, master bedroom and a bathroom. First floor flat:- Entrance hallway, lounge, kitchen, master bedroom, bathroom and a second bedroom.

Externally there is a rear yard for each flat.

Council Tax Band: A

Tenure: Leasehold

Length of Lease: 984

Price: Starting Bid £80,000

Property Type: Pair of Flats

Parking: On Street

Heating: Gas

## Master bedroom

4.25m x 4.36m (13'11" x 14'3")

Double glazed window and an gas central heating radiator.



## Bedroom Two

2.77m x 2.32m (9'1" x 7'7")

Double glazed window and a gas central heating radiator.



## Kitchen

2.84m x 2.64m (9'3" x 8'7")

Double glazed window, gas central heating radiator, sink unit, plumbed for washer, electric oven, gas hob with an extractor hood, fitted wall and base unit with roll top work surfaces and door to the external.



## Lounge

4.31m x 4.13m (14'1" x 13'6")

Double glazed window and a gas central heating radiator.

## First floor flat

Entrance hallway

## Rear yard



## Ground floor bathroom

Low level W/C, wash hand basin, Panelled bath with a shower above. double glazed window and a gas central heating radiator.



## Ground floor Master bedroom

4.25m x 4.36m (13'11" x 14'3")

Double glazed window and a gas central heating radiator.



## Ground floor kitchen

2.84m x 2.64m (9'3" x 8'7")

Double glazed window, sink unit with mixer, plumbed for washer, electric oven, gas hob with an extractor hood, fitted wall and a roll top work surfaces and a door to the external.



## Ground floor Lounge

4.31m x 4.13m (14'1" x 13'6")

Double glazed window and gas central heating radiator.



## Entrance hallway

## Ground floor flat

## Bathroom

Low level W/C, panelled bath with shower above, wash hand basin, double glazed window and a gas central heating radiator.



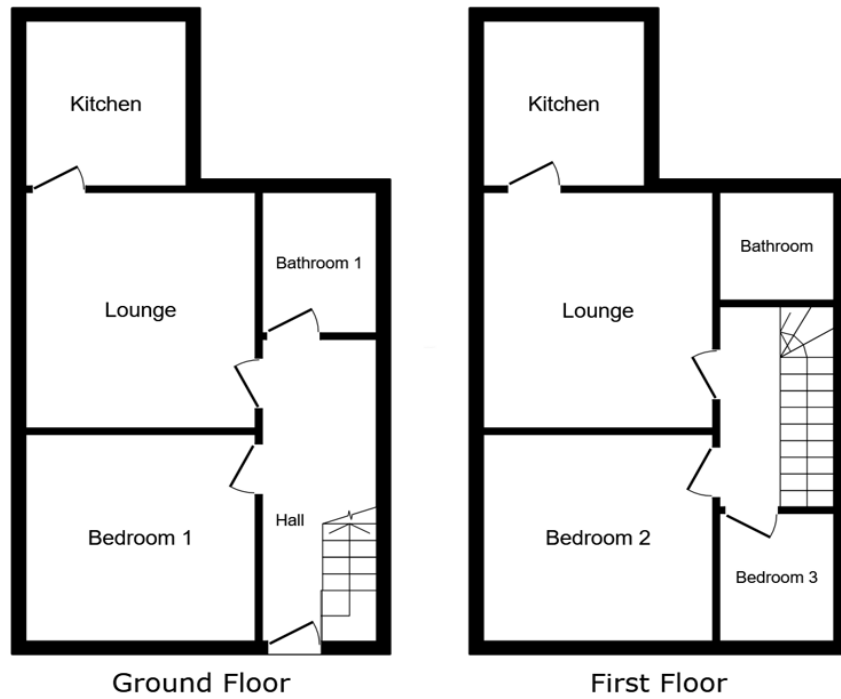

This floor plan is for illustrative purposes only. It is not drawn to scale. Any measurements, floor areas (including any total floor area), openings and orientations are approximate. No details are guaranteed, they cannot be relied upon for any purpose and do not form any part of any agreement. No liability is taken for any error, omission or misstatement. A party must rely upon its own inspection(s). Powered by [www.Propertybox.io](http://www.Propertybox.io)

Energy Efficiency Rating		Current	Potential
<i>Very energy efficient - lower running costs</i>			
(92-100) <b>A</b>			
(81-91) <b>B</b>			
(69-80) <b>C</b>			77
(55-68) <b>D</b>	66		
(39-54) <b>E</b>			
(21-38) <b>F</b>			
(1-20) <b>G</b>			
<i>Not energy efficient - higher running costs</i>			
<b>England, Scotland &amp; Wales</b>		EU Directive 2002/91/EC	

Mitchell Street, South Moor, Stanley, Durham, DH9 7BE

Contact your local branch today for more information on this property:

**235 Church Street, Blackpool, Lancashire, FY1 3PB, <http://www.kenricksestateagents.co.uk/>**

These particulars, whilst believed to be accurate are set out as a general outline only for guidance and do not constitute any part of an offer or contract. Intending purchasers should not rely on them as statements of representation of fact, but must satisfy themselves by inspection or otherwise as to their accuracy. No person in this firm's employment has the authority to make or give any representation or warranty in respect of the property.

